

 NETRO

# PIXIE

The Smart Hose Faucet Timer

Quick start guide

## Meet the Watering System of the Future

For user manuals in other languages, please visit  
[netrohome.com](http://netrohome.com)

# Meet Pixie, the Smart Hose Faucet Timer

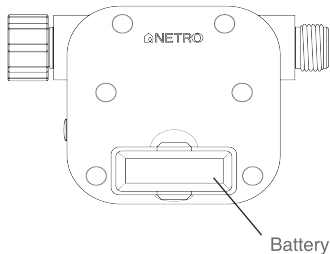
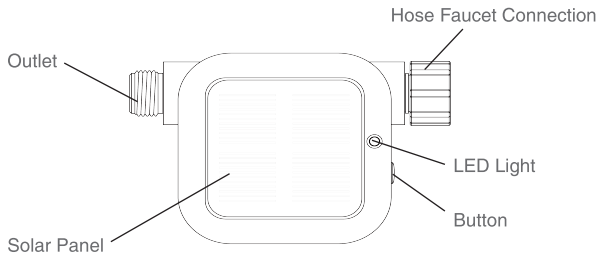

# The Netro App

- 1** Download the Netro app. If you do not already have the Netro app on your mobile device, search for Netro and download the free Netro app in Google Play store or App Store.
- 2** Launch the Netro app. Create a Netro account or login with an existing Netro account to start setting up the timer. If you are using other Netro products, you do not need to create another account, instead you can add your timer to the same account.

## Setup the Timer in the app

- 1** Turn on your timer by pressing the button on the unit for 3 seconds. The timer will also turn on automatically when the battery is installed.
- 2** The first time you turn on your timer, the LED light will start to blink in white color, indicating that it is ready to connect to WiFi (we call this “HOST” mode). If you are not ready to connect yet, no worries. Press the button for 3 seconds again to turn off your timer.
- 3** Stay close to your router, follow the steps in the Netro app to add your timer to your Netro account.

## Install the Timer

- 1 Connect the timer to an outdoor hose faucet.

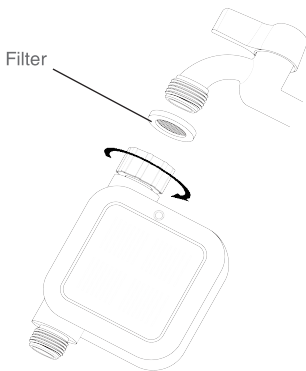

## Install the Timer

### 2 Test the WiFi signal.

1. Press the power button for 3 seconds to turn on the timer. If the timer is already on, turn it off first by pressing the power button for 3 seconds.
2. The timer will try to connect to the router.
3. Wait for 15-30 seconds.
4. If the connection is successful, the LED light will become green.
5. If the connection is unsuccessful, the LED will turn red. You might need to move closer to the router (within 100 feet in most cases).

### 3 Turn on your water. The water must remain on for the timer to work properly. Make sure there is no water leakage before you leave.

### 4 Quickly press the button twice to test the water. Quickly press the button twice again to manually turn off the water.

### 5 The timer will go to sleep mode in a few minutes to save power.

## Battery

Your Pixie is powered by a rechargeable advanced lithium battery which is charged by solar energy.

1 hour of charge can generally provide 1-2 days of normal operation.

### **Sunlight Requirements:**

Make sure the solar panel can receive at least 1 hour of direct sunlight on a sunny day. In cloudy weather conditions, try to position the solar panel to allow as much access to sunlight as possible.

### **What if the battery on the timer runs out?**

The timer will stop functioning. When you press the power button, the LED light will flash in red indicating low battery. You will have to use sunlight to charge it for at least 4 hours before turning it on again. If your battery is not holding a charge, or you believe it has stopped working, please email to [support@netrohome.com](mailto:support@netrohome.com). Do not open the battery.



## Battery

You can also remove the battery from the timer and charge it through the included cable.

1. Remove the battery from the back of the timer.

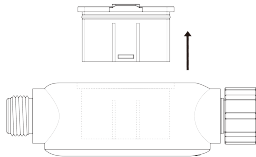

2. Plug in the included cable to charge the battery from a USB port. The light on the battery will change from red to green when the battery is fully charged.

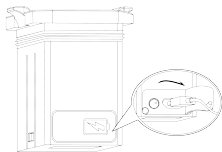

## The LED Light

The LED light on your Pixie has 5 possible statuses:

**Blinking slowly in white:** the timer is in its HOST mode. This happens when you first turn on your timer or reset it, and indicates that it needs to go through the setup steps in the app to connect to a home WiFi network.

**White:** the timer is starting up and will try to connect to the WiFi network.

**Green:** the timer is connected to the WiFi network.

**Red:** the timer is unable to connect to the WiFi network.

**Blue:** the timer is watering.

# The Button

The button can be used to power on/off the timer, manually turn on/off the water and reset the timer to its HOST mode for WiFi setup.

**Power on the timer:** Press the button for 3 seconds. Wait until the LED light becomes green or red. If the LED light does not turn on or flashes in red immediately, the battery is low in energy and needs to be charged.

**Power off the timer:** Press the button for 3 seconds.

**Manually turn on/off the water:** If the timer is off, power on the timer first. Make sure the LED light is green or red. Quickly press the button twice.

**Reset the timer to its HOST mode:** If the timer is off, power on the timer first. Make sure the LED light is green or red. Press the button for 12 seconds. The LED light will start blinking in white.

## Technical Specifications

**Dimensions:** 6.5 X 4.3 X 1.9 (inches)

**Weight:** 16 oz / 450 g

**WiFi:** 802.11 N, 2.4Ghz, US / Japan / EU

**Operating temperature range:** 32° to 122°F / 0°C to 50°C

**Water pressure:** 0.02MPa to 0.8Mpa

## Support

[support@netrohome.com](mailto:support@netrohome.com)

FCC Compliance Notice and other legal information:  
visit [netrohome.com](http://netrohome.com)

## Limited Warranty

Netro Inc., Portland, Oregon USA, warrants to the owner of the enclosed product that the product contained in the box will be free from defects in materials and workmanship for a period of two (2) years from the date of delivery following the original retail purchase. If the Product fails to conform to this Limited Warranty during the Warranty Period, Netro Inc. will repair or replace any defective product or component.

## IMPORTANT INFORMATION ABOUT LIMITATIONS AND EXCLUSIONS

IN NO EVENT WILL NETRO BE LIABLE FOR ANY CONSEQUENTIAL, INCIDENTAL, EXEMPLARY, OR SPECIAL DAMAGES, INCLUDING ANY DAMAGES FOR LOST DATA OR LOST PROFITS, ARISING FROM OR RELATING TO THIS LIMITED WARRANTY OR THE PRODUCT, AND NETRO'S TOTAL CUMULATIVE LIABILITY ARISING FROM OR RELATED TO THIS LIMITED WARRANTY OR THE PRODUCT WILL NOT EXCEED THE AMOUNT ACTUALLY PAID FOR THE PRODUCT BY THE ORIGINAL PURCHASER.





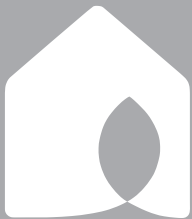

Netro INC.